

The  
**OASIS**  
GRAND 14  
Facing Eiffel Tower & Park



**500 Sqft**

## Luxury 1 Bed Apartment

Facing Eiffel Tower Park & Fountains

| Gross Sqft | 20% Booking | 20% Confirmation | 36 Installments | Total     |
|------------|-------------|------------------|-----------------|-----------|
| 500        | 1,700,000   | 1,700,000        | 141,667         | 8,500,000 |
| 515        | 1,751,000   | 1,751,000        | 145,917         | 8,755,000 |
| 525        | 1,785,000   | 1,785,000        | 148,750         | 8,925,000 |
| 532        | 1,808,800   | 1,808,800        | 150,733         | 9,044,000 |
| 540        | 1,836,000   | 1,836,000        | 153,000         | 9,180,000 |
| 550        | 1,870,000   | 1,870,000        | 155,833         | 9,350,000 |

**Note: Corner, Facing Park & Fountains units come with a premium of 10% additional charges**

Rate  
Sqft ~~18,000~~ **17,000**

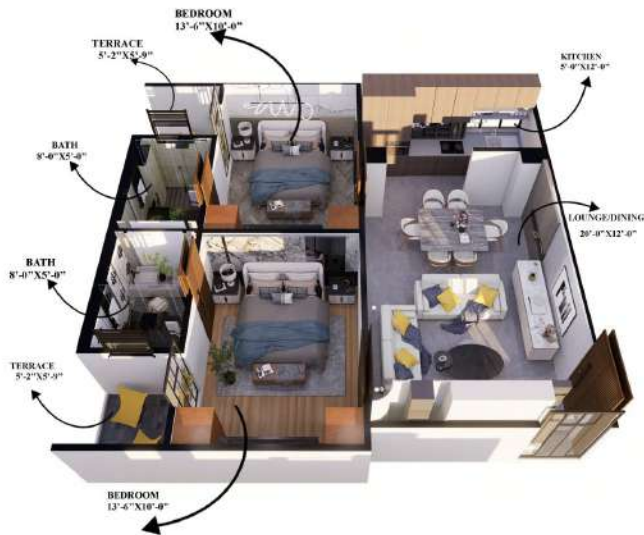

## Luxury 2 Bed Apartment

Facing Eiffel Tower Park & Fountains

| Gross Sqft | 20% Booking | 20% Confirmation | 36 Installments | Total      |
|------------|-------------|------------------|-----------------|------------|
| 1,000      | 3,400,000   | 3,400,000        | 283,334         | 17,000,000 |

The  
**OASIS**  
GRAND 14  
Facing Eiffel Tower & Park

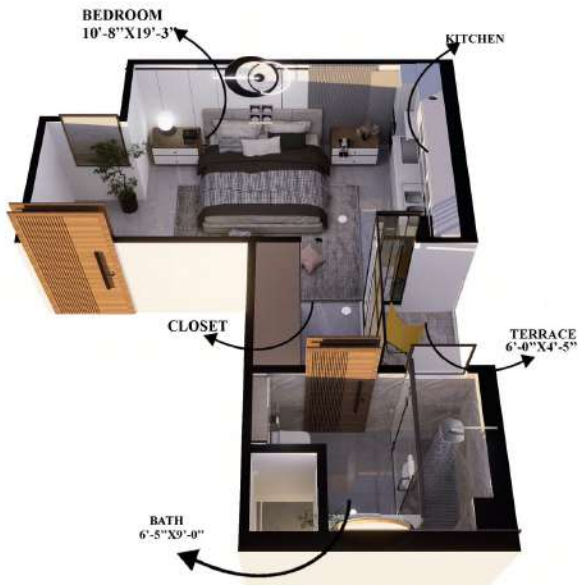

Rate  
Sqft ~~18,000~~ **17,000**



## Luxury Studio Apartments

Facing Eiffel Tower Park & Fountains

| Gross Sqft | 20% Booking | 20% Confirmation | 36 Installments | Total     |
|------------|-------------|------------------|-----------------|-----------|
| 365        | 1,241,000   | 1,241,000        | 103,417         | 6,205,000 |
| 375        | 1,275,000   | 1,275,000        | 106,250         | 6,375,000 |
| 380        | 1,292,000   | 1,292,000        | 107,667         | 6,460,000 |
| 400        | 1,360,000   | 1,360,000        | 113,333         | 6,800,000 |
| 420        | 1,428,000   | 1,428,000        | 119,000         | 7,140,000 |

Note: Corner, Facing Park & Fountains units come with a premium of 10% additional charges